

Sectional drawings

Standard design NCT

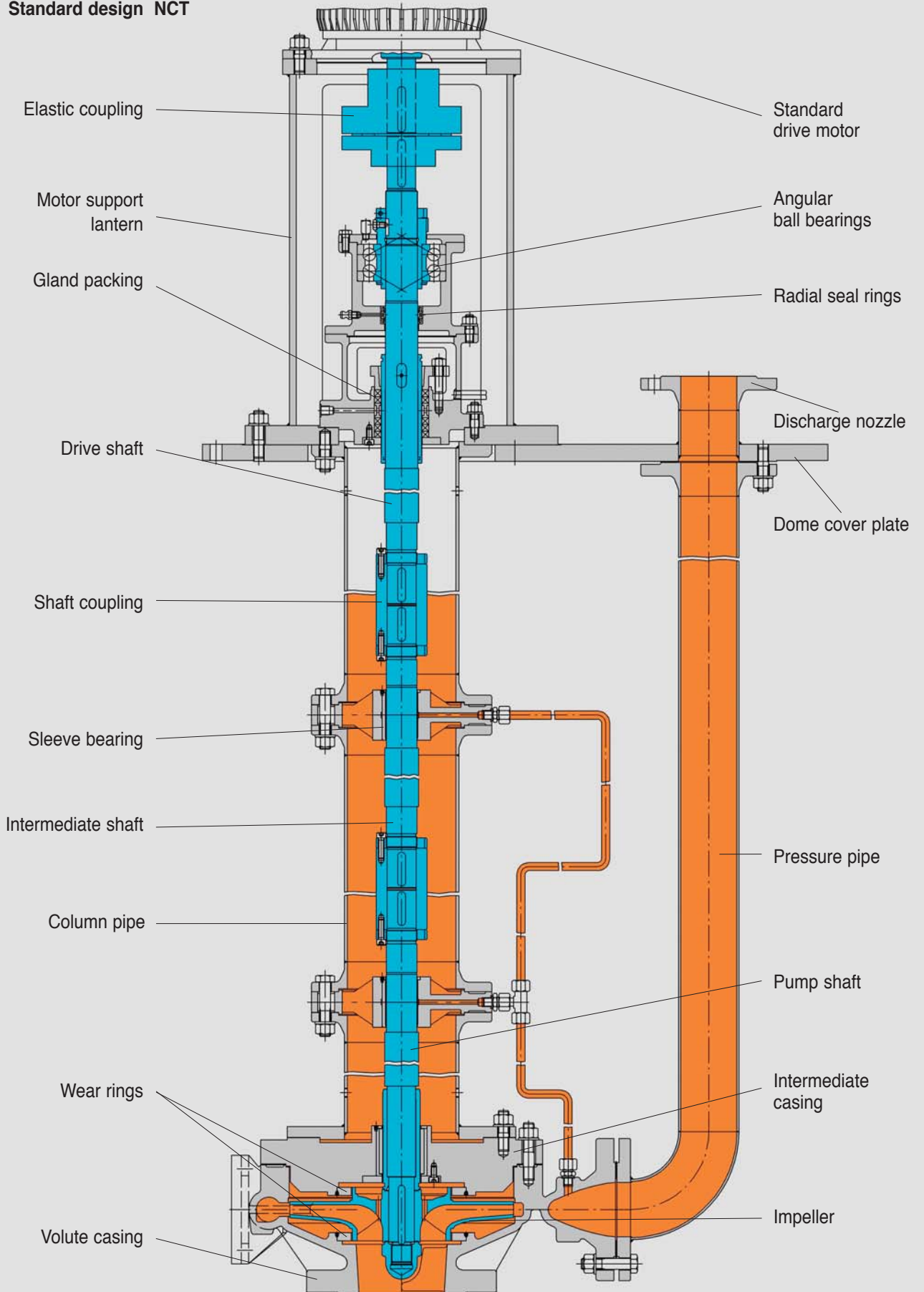

Optional designs

Magnetic coupled design, type NMT

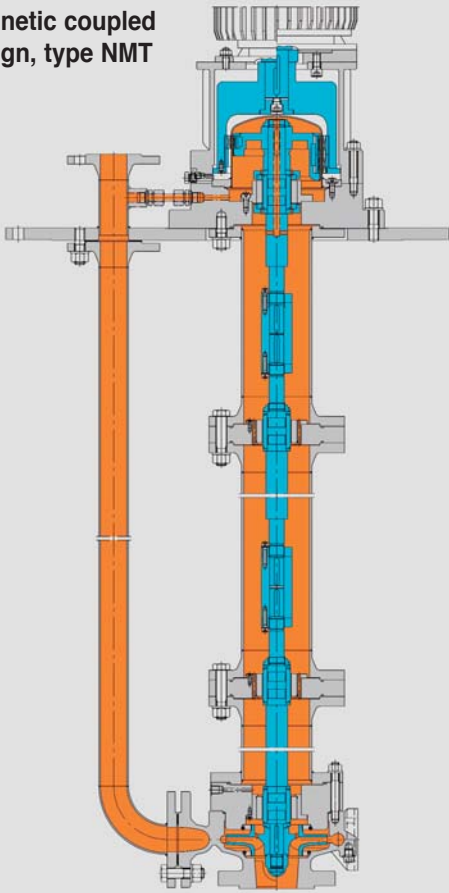

Type approved ATEX design, NCT Cat.1

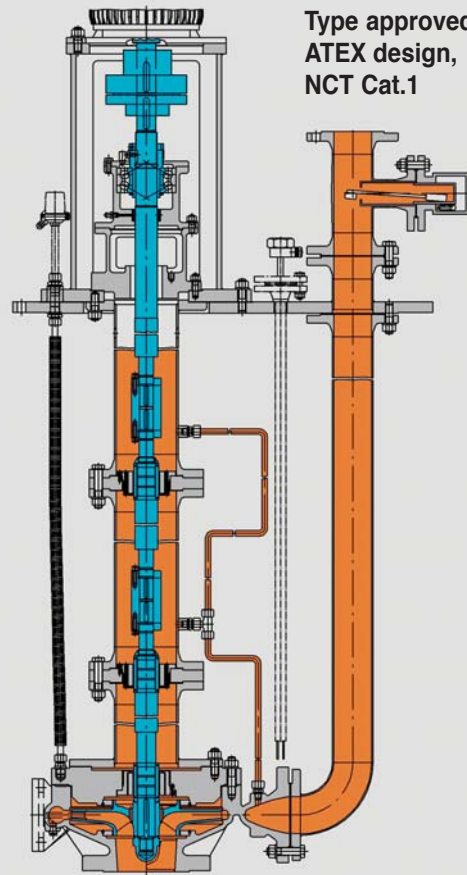

Cantilever design, type NCTk

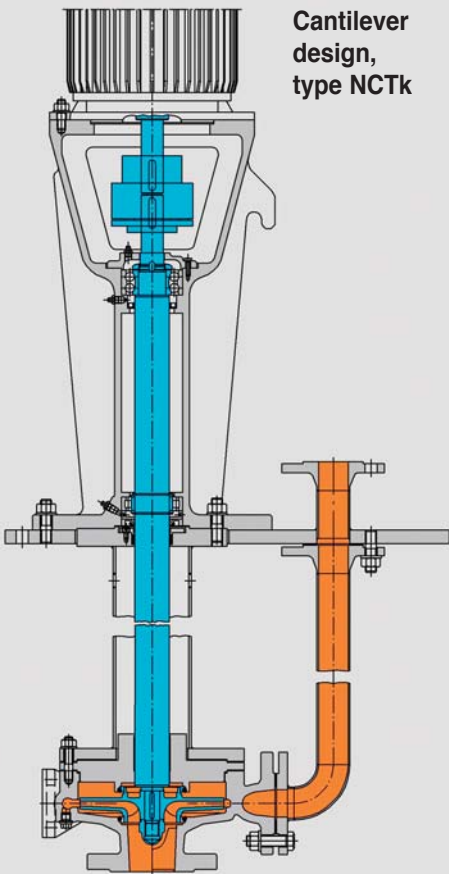

Jacketed design, type NCTb

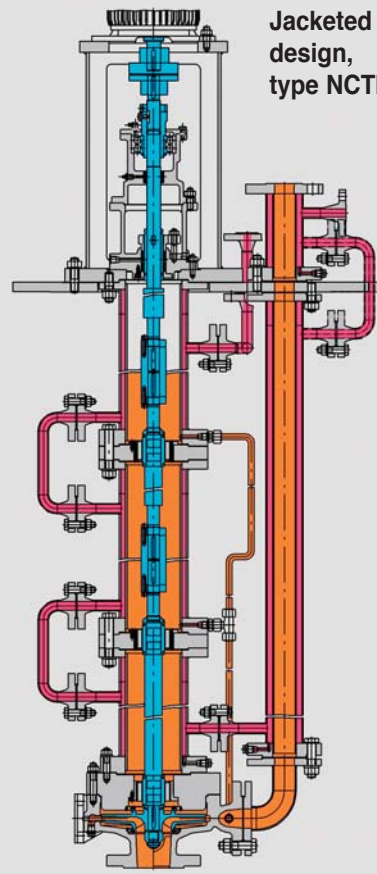

Optional designs

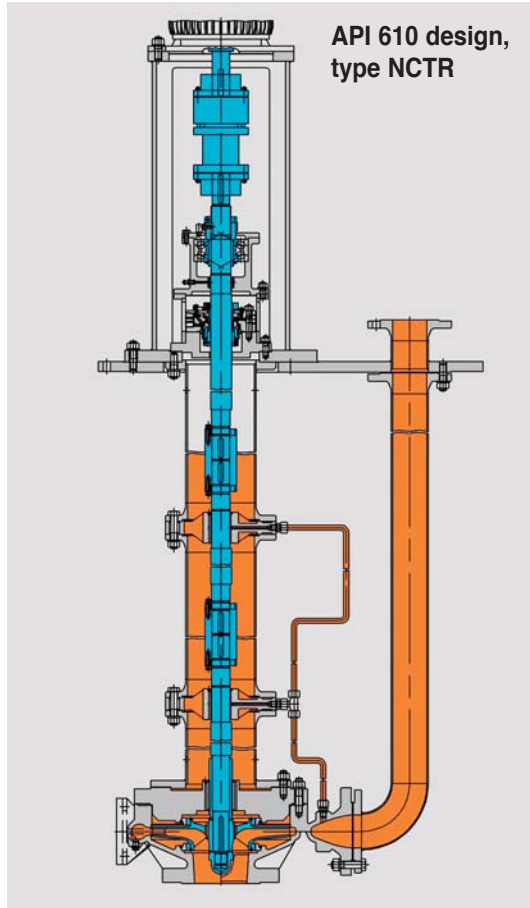

Design features:

- mechanical seal acc. to API 682
- impeller- and casing wear rings

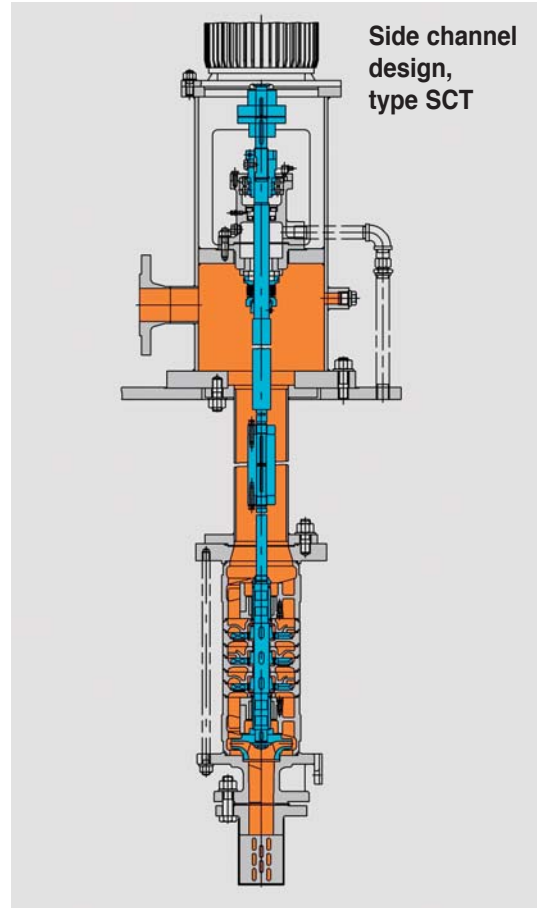

Special design for low flow and high head applications. Pump body and performance table is identical to type SC (see corresponding leaflet).

Shaft sealing

The drive shaft is sealed against the atmosphere by a shaft sealing arrangement, located in the motor support lantern. The shaft sealing is not pressurized by the pump itself. Besides the

standard gland packing with self-lubricating graphite ring, mechanical seals can also be applied. Retrofitting from packing to seal on site is possible without remachining any pump parts.

Double mechanical seal,
back-to-back arrangement

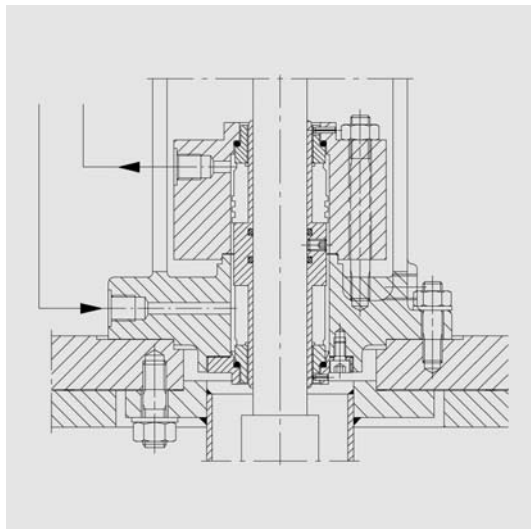

Single mechanical seal,
cartridge type acc. to API 682

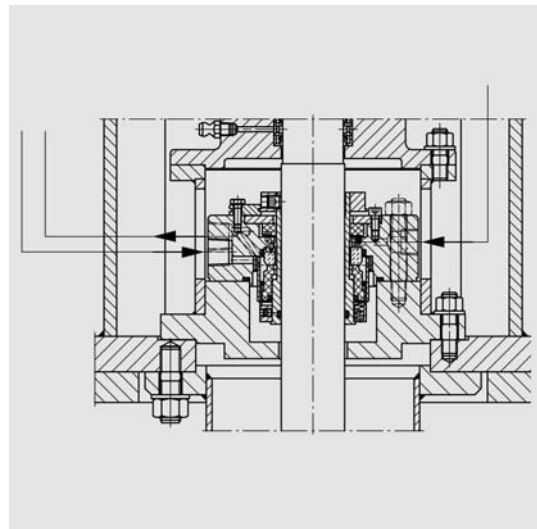

Performance range

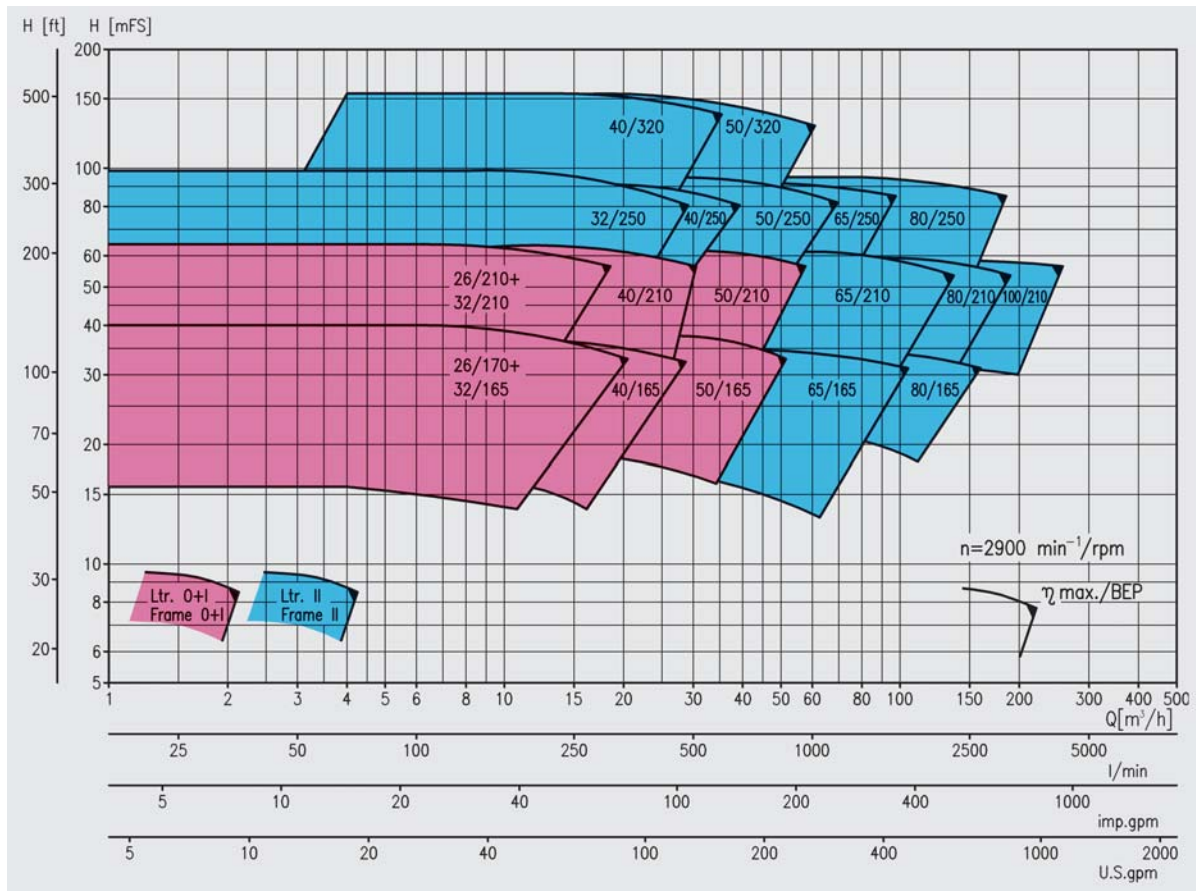
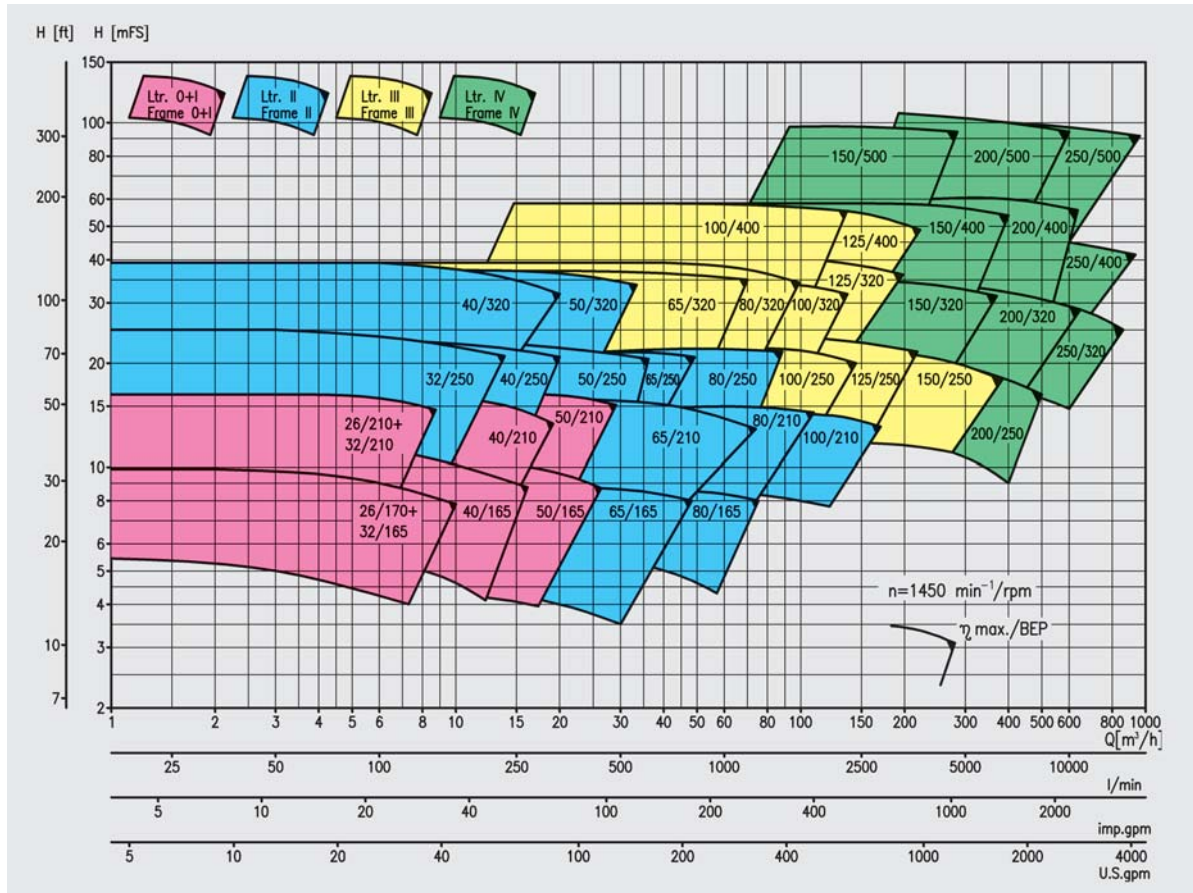

Performance curves for the different pump sizes are available on request and are supplied with our technical offers in general.